

The most important values at a glance

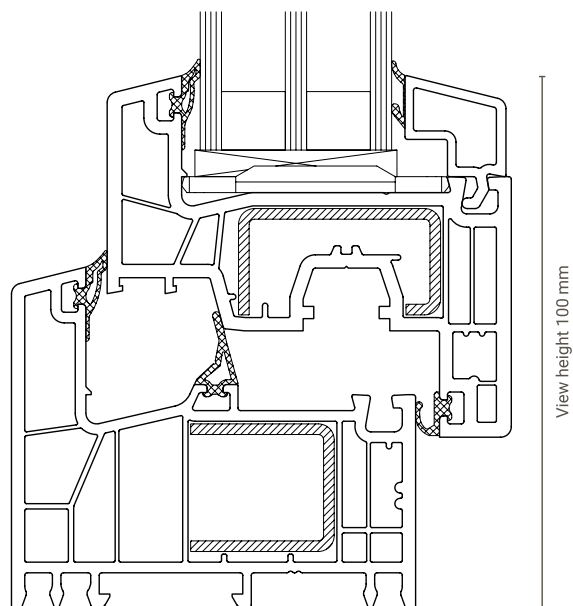

| | | |
|---------------------------|--|--|
| Thermal insulation | AD U_w up to 0.77 W/(m ² K) MD U_w up to 0.74 W/(m ² K) | AD U_i up to 1.2 W/(m ² K) MD U_i up to 1.1 W/(m ² K) |
| Sound proof | 47 dB | |
| Safety | up to RC3 | |
| Construction depth | 76 mm | |
| Sash view height | 36 mm | |
| Frame view height | 64 mm | |
| Maximum sizes | Standard sash: width up to max. 1,250 mm height up to max. 2,350 mm | |
| Types of opening | side-hung window, bottom hung window, and tilt and turn window | |

Subject to changes, errors, printing and type setting mistakes.

The ideal, most sustainable window material – PVC

We specialize in the production of window profiles using the sustainable and long-lasting material PVC and combine this with our innovative realMaterial surfaces. This enables us to create customized windows which not only suit the style of the building, but also bring it to life – on the outside and inside.

Our production facilities are powered by an ever increasing percentage of green electricity from renewable sources and our own water power plant.

